

PORTAVALIGIA SPECIFICO - SPECIFIC CASE HOLDER  
 PORTE-VALISE SPECIFIQUE - SPEZIFISCHER KOFFER-TRÄGER  
 PORTA-EQUIPAJE ESPECIFICO

# PIAGGIO X9 125/180/250

2000/2002

ISTRUZIONI DI MONTAGGIO - MOUNTING INSTRUCTIONS  
 INSTRUCTIONS DE MONTAGE - BAUANLEITUNG - INSTRUCCIONES DE MONTAJE

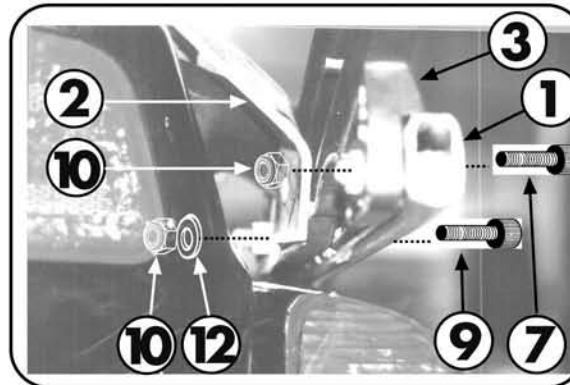
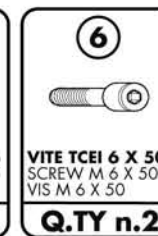
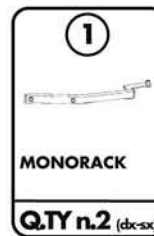
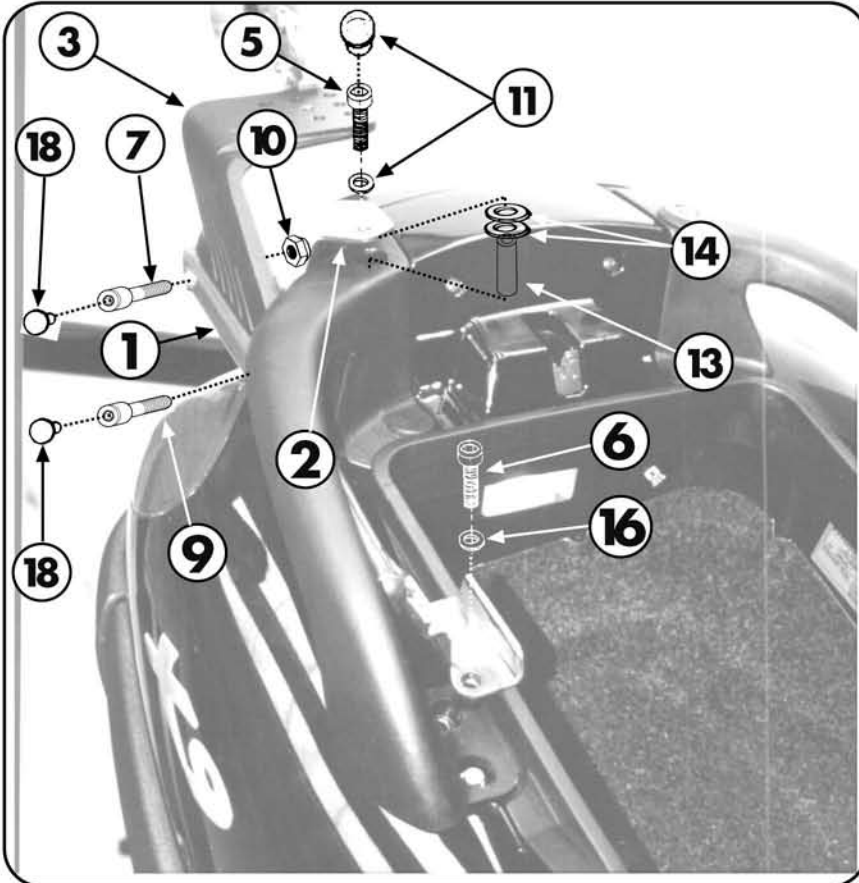

VISTA INTERNA MONTAGGIO SUPPORTO ED ALETTA POSTERIORI ( pz.2 e 3 )

INSIDE VIEW OF MOUNTING OF BACK SUPPORT AND FINN ( pcs. 2 and 3 )

VUE INTERIEURE DU MONTAGE SUPPORT ET AILETTE POSTERIEURES ( pcs. 2 et 3 )

